

Fixe suspendu par crochet (version perpendiculaire)
Hook suspended (perpendicular version)
Ortsfest mit Hakenaufhängung (Quer zur Kettenzugachse)

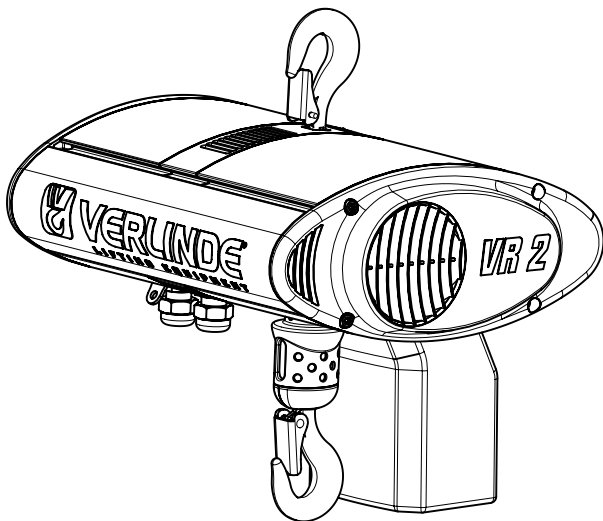

	Sans chaîne Without chain Ohne Kette	Avec 3m de chaîne With 3m of chain Mit 3m Kette
Poids Weight Gewicht	19.4 kg	20.5 kg

Fixe suspendu par oeillet (version perpendiculaire)
Eye suspended (perpendicular version)
Stationär Ösenaufhängung (Quer zur Kettenzugachse)

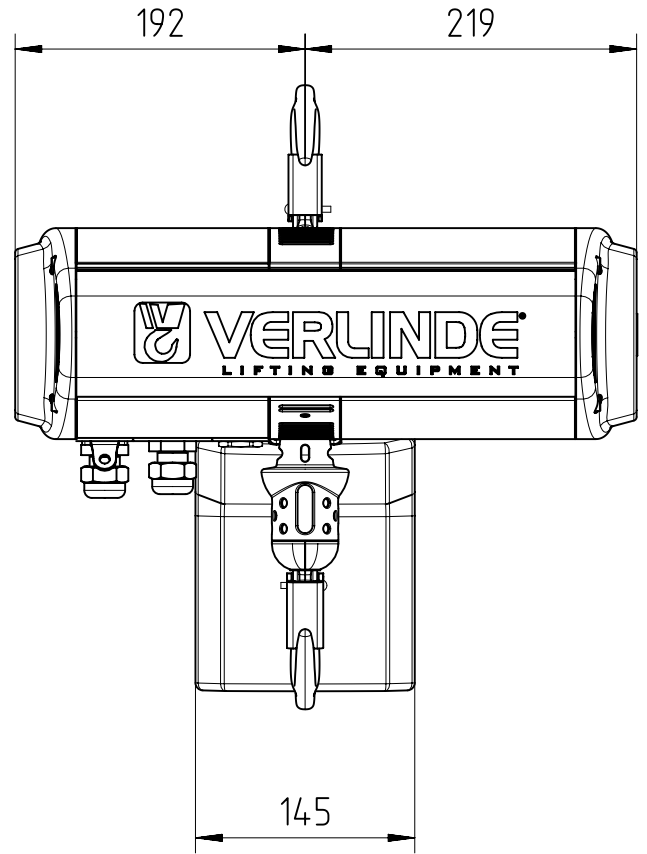
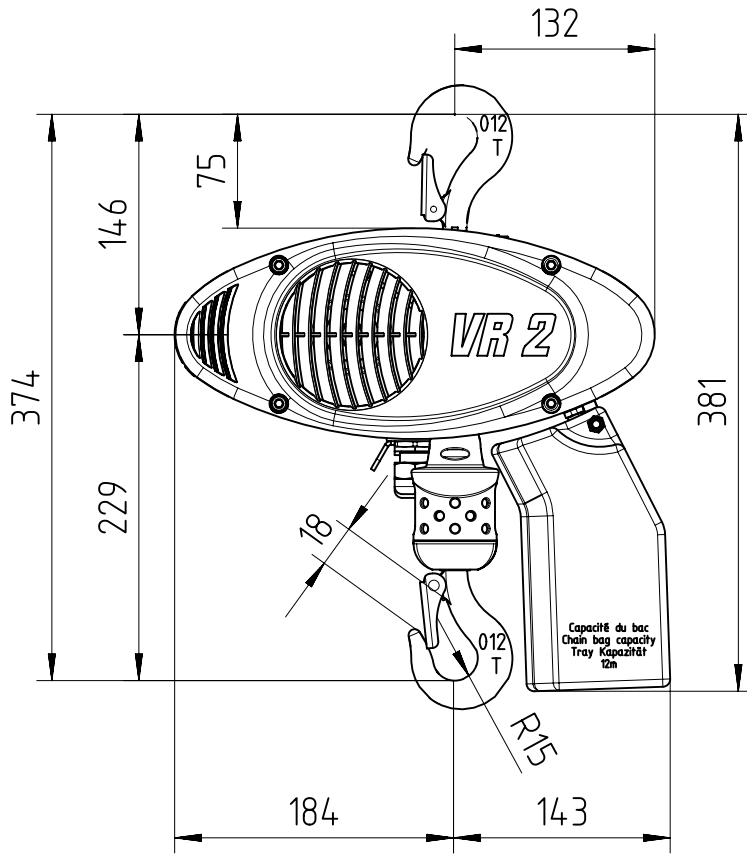
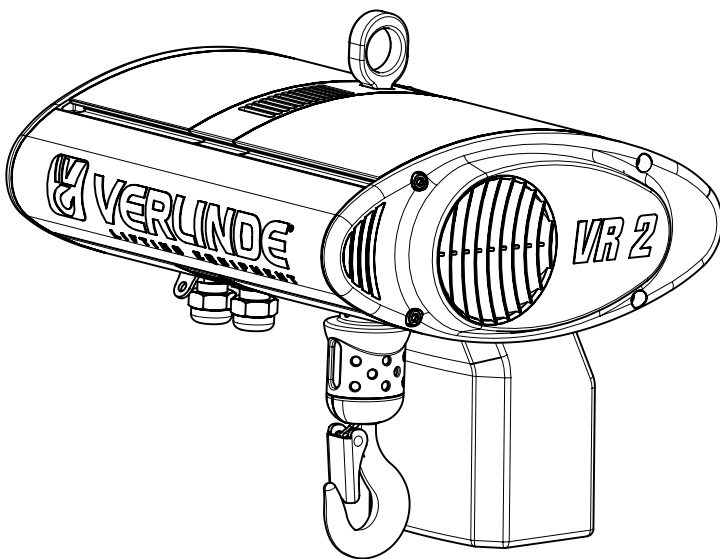
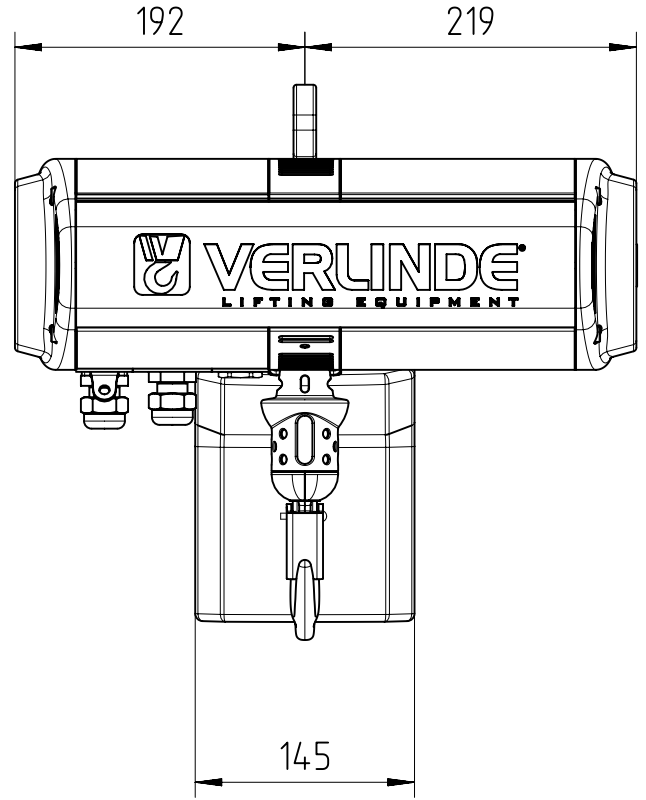
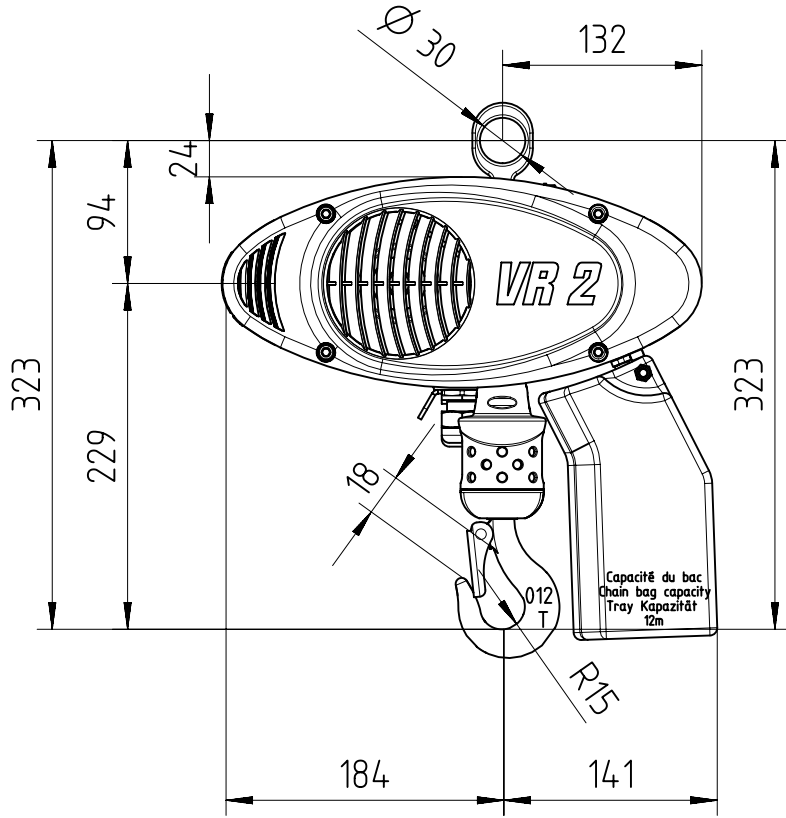

	Sans chaîne Without chain Ohne Kette	Avec 3m de chaîne With 3m of chain Mit 3m Kette
Poids Weight Gewicht	19.2 kg	20.3 kg

Accroché à chariot manuel CHD 500kg (version perpendiculaire)
Hooked to CHD 500kg (perpendicular version)
Mit Schiebefahrwerk CHD 500kg (Quer zur Kettenzugachse)

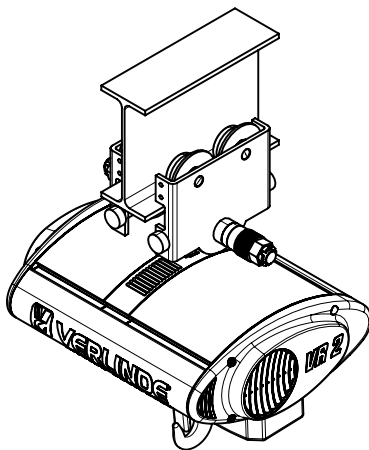
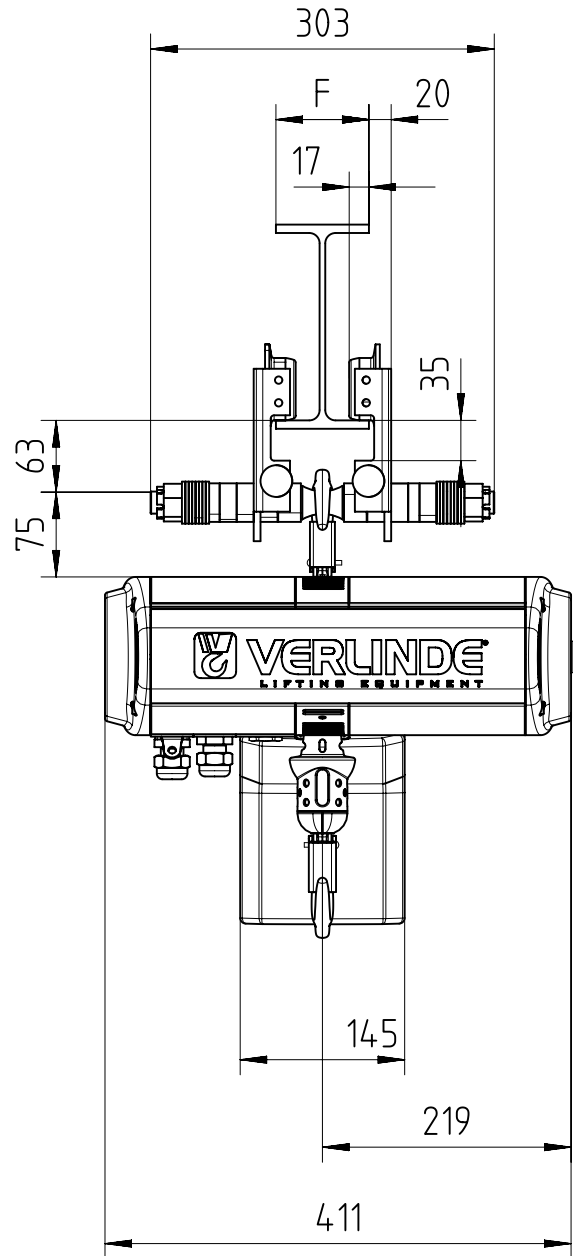
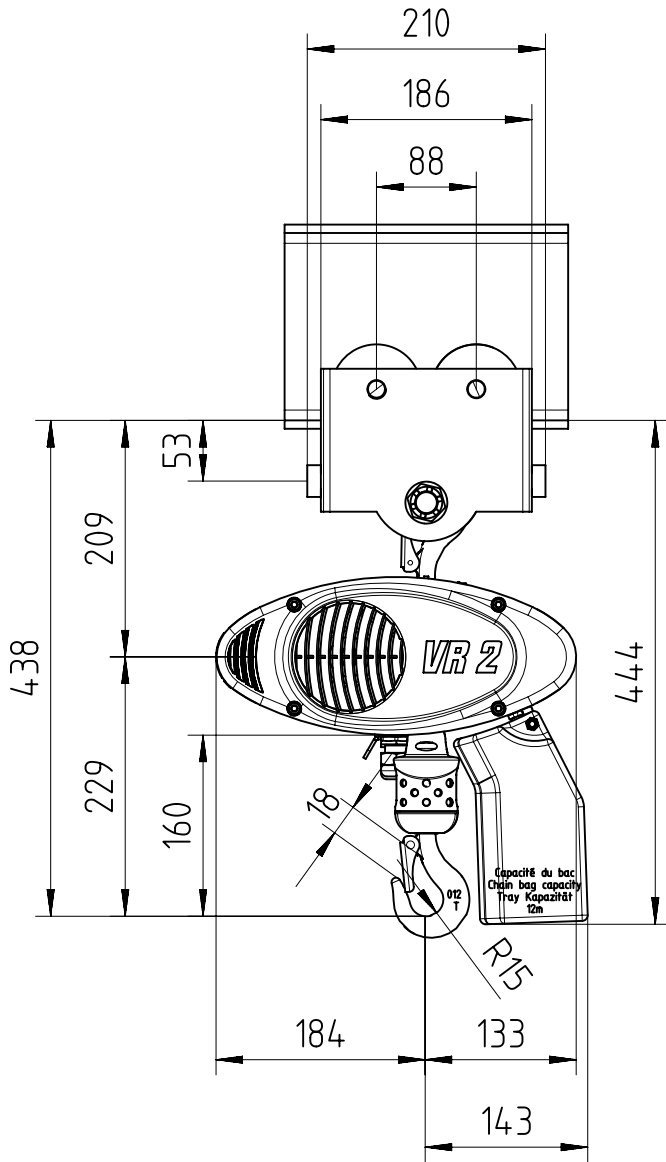

$$50 < F < 202$$

	Sans chaîne Without chain Ohne Kette	Avec 3m de chaîne With 3m of chain Mit 3m Kette
Poids Weight Gewicht	25.9 kg	27 kg

Accouplé à chariot à direction électrique CHV 1000kg (version perpendiculaire)
Fixed to electric travel trolley CHV 1000kg (perpendicular version)
Mit Motorfahrwerk CHV 1000kg (Quer zur Kettenzugachse)

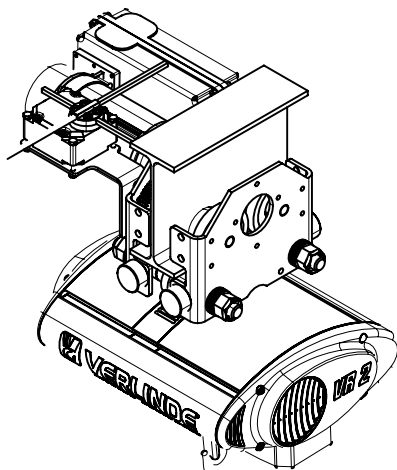
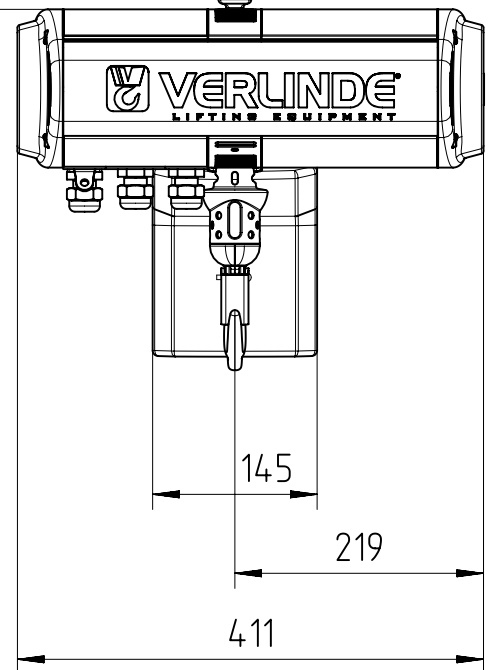
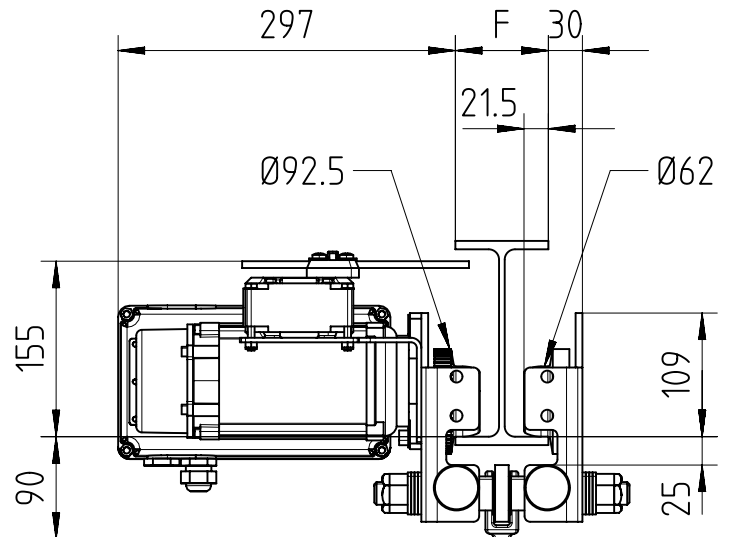
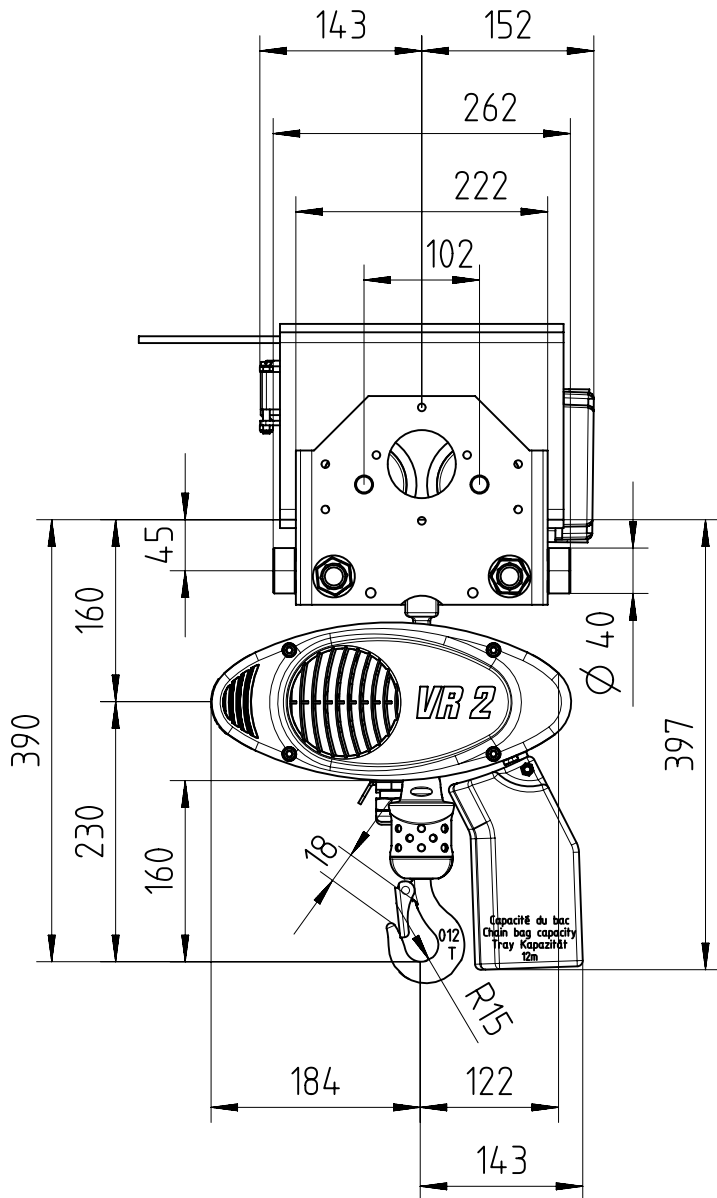

$55 < F < 310$

	Sans chaîne Without chain Ohne Kette	Avec 3m de chaîne With 3m of chain Mit 3m Kette
Poids Weight Gewicht	40.9 kg	42 kg

Chariot électrique (hauteur perdue réduite - déport court)
With electric travel trolley (short headroom - short overreach)
Mit Motorfahrwerk (Kurze Bauhöhe - Kurzer Radstand)

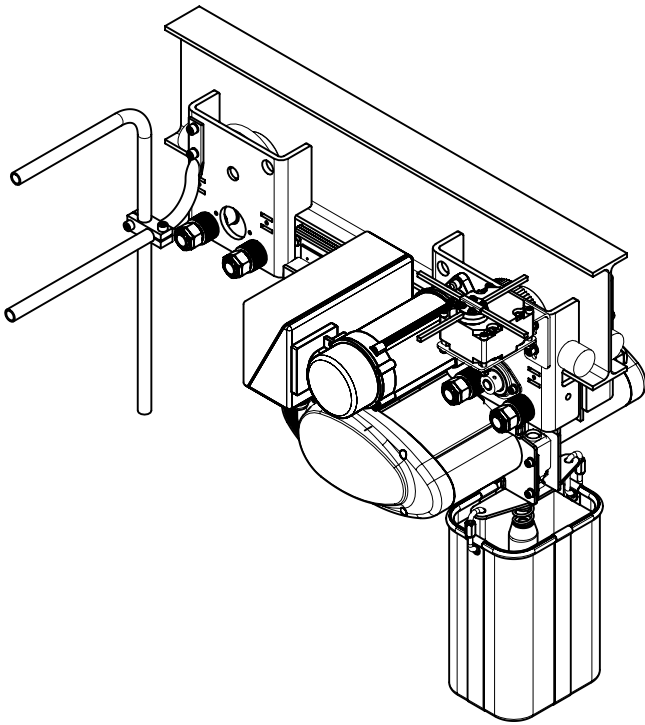
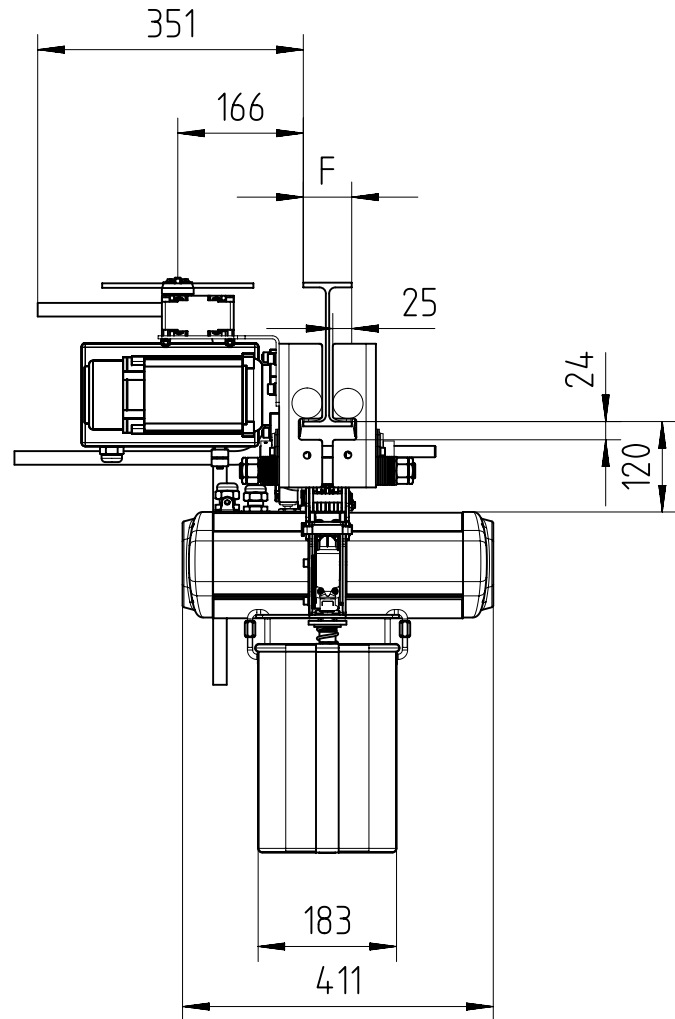
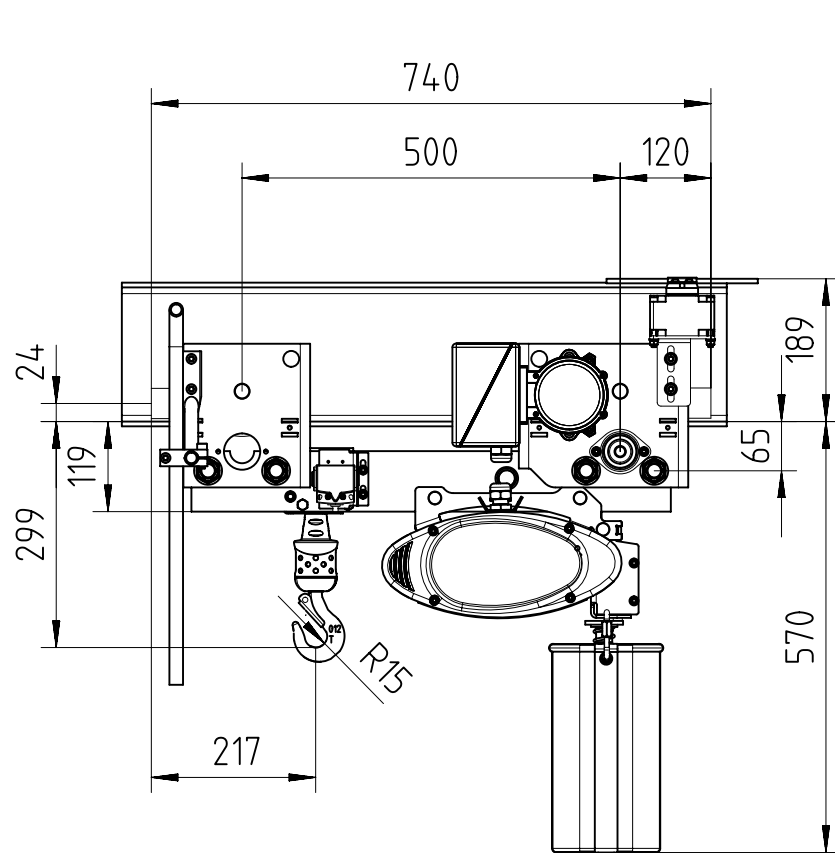

$55 < F < 310$

	Sans chaîne Without chain Ohne Kette	Avec 3m de chaîne With 3m of chain Mit 3m Kette
Poids Weight Gewicht		